



# **GAS STOVES**

## **FREESTANDING GAS STOVES**



[regency-fire.com](https://www.regency-fire.com)

# REGENCY CONTURA RC500E

Medium Gas Stove



RC500E shown in black cast with volcanic stones and rear venting (unit shown without mandatory safety screen).

## 3-SIDED GAS STOVE

With clean lines, three-sided viewing and a large door, the RC500E gives a light and modern impression to any home. Available in black or white, you can customize this modern gas stove with a traditional log set or volcanic stones on a bed of large crushed glass crystals. The curved design invites you to enjoy a stunning flame view from three sides.

| SPECIFICATIONS                 | NATURAL GAS | PROPANE |
|--------------------------------|-------------|---------|
| Maximum BTU                    | 23,000      | 22,000  |
| Turn down to (BTU)             | 16,000      | 18,000  |
| Efficiency (steady state)      | 67.13%      | 66.85%  |
| EnerGuide rating (Canada only) | 60.38%      | 61.42%  |



RC500E shown in white cast with glass door & top with traditional logs and top venting (unit shown without mandatory safety screen).

## STANDARD FEATURES

- View the stunning flame from three sides
- Interior lights for added ambiance
- Variable speed blower
- Natural gas
- Safety screen
- Electronic ignition with remote control
- Modulating flame adjustment
- Battery back up system keeps the heat on in the event of a power outage
- Direct vent
- Reversible flue for top or rear venting

## OPTIONS

- Available in black cast or white with glass door & top
- Your choice of crystals, volcanic stones or traditional logs
- Propane conversion kit
- AstroCap™ Venting System
- Vertical or horizontal direct vent terminations



RC500E shown with safety screen

# REGENCY ULTIMATE™ U38 • U39

Medium Gas Stoves



U39E shown with wrap around brushed nickel door, brushed nickel louvers and traditional log set (unit shown without mandatory safety screen).

## MODERN FIRE

The clean, modern lines of the Ultimate line of gas stoves provide exceptional views of the fire with the wraparound design meant to maximize your enjoyment of the flames. Your Ultimate fire can be turned up to the maximum heat setting to provide high efficiency or turned down to maintain ambiance with less heat. Warm-up your kitchen, bedroom, or den with these efficient and versatile gas stoves.

| SPECIFICATIONS<br>(NATURAL GAS)   | U38    | U38E   | U39    | U39E   |
|-----------------------------------|--------|--------|--------|--------|
| Maximum BTU                       | 38,000 | 38,000 | 38,000 | 38,000 |
| Turn down to (BTU)                | 26,000 | 26,000 | 26,000 | 26,000 |
| Efficiency<br>(steady state)      | 71.63% | 71.63% | 77%    | 77%    |
| EnerGuide rating<br>(Canada only) | 63.94% | 63.94% | 73.45% | 73.45% |

| SPECIFICATIONS<br>(PROPANE)       | U38    | U38E   | U39    | U39E   |
|-----------------------------------|--------|--------|--------|--------|
| Maximum BTU                       | 34,000 | 34,000 | 38,000 | 38,000 |
| Turn down to (BTU)                | 27,500 | 26,000 | 30,000 | 30,000 |
| Efficiency<br>(steady state)      | 71.71% | 71.71% | 77.80% | 77.80% |
| EnerGuide rating<br>(Canada only) | 64.59% | 64.59% | 75.68% | 75.68% |



U38E shown with wrap around black door, black louvers and driftwood log set (unit shown without mandatory safety screen).

## STANDARD FEATURES

- Natural gas
- Safety screen
- Flame height adjustment
- Electronic Ignition (U38E, U39E)
- Millivolt system with proflame remote control (U39)
- Proflame II Remote Control (U38E, U39E)
- B-vent (U38E)
- Direct Vent (U39, U39E)
- Black steel pedestal
- Pedestal side panels
- Variable speed blower
- 1-piece wrap around door in brushed nickel or black
- Battery back up system keeps the heat on in the event of a power outage

## OPTIONS

- Choose between natural oak or driftwood logs
- Brushed nickel or black louvers
- Wall thermostat
- BTU reduction kit
- Propane conversion kit
- AstroCap™ Venting System (U39, U39E)
- Vertical or horizontal direct vent terminations (U39, U39E)



U38E shown with safety screen

# REGENCY HAMPTON H15 • H27 • H35

Small, Medium & Large Gas Stoves



H27E shown with decorative glass grille in charcoal gray finish.

## HIGH-EFFICIENCY HEAT

The Hampton series of gas stoves provides the beautiful look of cast iron stoves with Regency's unmatched fire and log packages. Enjoy the ultimate convenience of a gas fire available at the press of a button with the stunning visual of a realistic flame in a cast iron freestanding stove. Available in three sizes, Hampton gas stoves heat your home while saving you money on your heating bill.

| <b>SPECIFICATIONS<br/>(NATURAL GAS)</b> | <b>H15<br/>SMALL</b> | <b>H27<br/>MEDIUM</b> | <b>H35<br/>LARGE</b> |
|---|----------------------|-----------------------|----------------------|
| Maximum BTU                             | 18,000               | 25,000                | 30,000               |
| Turn down to (BTU)                      | 12,700               | 18,000                | 21,500               |
| Efficiency (steady state)               | 61.97%               | 67.63%                | 75.27%               |
| EnerGuide rating<br>(Canada only)       | 55.33%               | 61.22%                | 70.86%               |

| <b>SPECIFICATIONS<br/>(PROPANE)</b> | <b>H15<br/>SMALL</b> | <b>H27<br/>MEDIUM</b> | <b>H35<br/>LARGE</b> |
|-------------------------------------|----------------------|-----------------------|----------------------|
| Maximum BTU                         | 18,000               | 22,000                | 29,500               |
| Turn down to (BTU)                  | 15,500               | 17,500                | 24,000               |
| Efficiency (steady state)           | 63.69%               | 66.51%                | 75.77%               |
| EnerGuide rating<br>(Canada only)   | 57.46%               | 63.07%                | 71.97%               |



H35E shown with decorative glass grille in timberline brown enamel finish.



H35 in seaside sand enamel finish with decorative glass grille



H27 in timberline brown enamel finish with decorative glass grille



H15 in timberline brown enamel finish with decorative glass grille



H15 in charcoal gray finish with decorative glass grille

## STANDARD FEATURES

- Natural Gas
- Accent light
- ProFlame II remote control (GTMFL)
- Thermostat (built into remote)
- Modulating flame adjustment
- Light
- Safety screen
- Cast grille
- Ceramic glass
- Reversible flue for top or rear venting

## OPTIONS

- Charcoal gray, timberline brown enamel finish, and seaside sand finish (H35E)
- Brick panels in red or brown (H35E)
- Variable speed blower
- Wall thermostat
- AstroCap™ vent system (Not available on cream enamel finish)
- Color match vent paint
- Propane conversion kit
- Standing pilot models available in select regions

# REGENCY CLASSIC™ C34

## Small Gas Stove



C34 shown with black legs, black door and safety screen.

### CLASSIC FIRE

The Regency Classic gas stoves provide the traditional look of a wood stove, but with the convenience of gas. These stoves do not require an existing chimney and can be installed with a direct vent to use outside air for combustion, allowing your home to stay warmer. This Classic series, like all Regency gas stoves, operates safely without electricity - keeping you warm with radiant heat.

| SPECIFICATIONS (NATURAL GAS)   | C34    | C34E   |
|--------------------------------|--------|--------|
| Maximum BTU                    | 32,000 | 32,000 |
| Turn down to (BTU)             | 21,000 | 21,000 |
| Efficiency (steady state)      | 71.68% | 71.68% |
| EnerGuide rating (Canada only) | 63.49% | 64.89% |

| SPECIFICATIONS (PROPANE)       | C34    | C34E   |
|--------------------------------|--------|--------|
| Maximum BTU                    | 29,000 | 29,000 |
| Turn down to (BTU)             | 23,000 | 23,000 |
| Efficiency (steady state)      | 72.02% | 72.03% |
| EnerGuide rating (Canada only) | 64.49% | 65.82% |

### STANDARD FEATURES

- Natural gas or propane
- Beautiful fire with glowing logs
- Safety screen
- Flame height adjustment
- Millivolt system with Proflame remote control (US only)
- Electronic Ignition with Proflame II remote control (Canada Only)
- Direct Vent
- Convector Airmate
- Heavy-duty ceramic safety glass
- Battery back up system keeps the heat on in the event of a power outage

### OPTIONS

- Wall thermostat
- Variable speed blower
- Black steel pedestal base
- Cast iron door in black\*\* or nickel accent
- Cast iron legs in brushed nickel or black
- Bottom heat shield (when using legs)
- AstroCap™ Venting System
- Vertical or horizontal direct vent terminations

\*\* Black doors come with black wood handles & black hinge caps



# SPECIFICATIONS

## DIMENSIONS

### C34

#### PEDESTAL

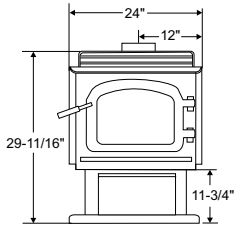

#### TOP

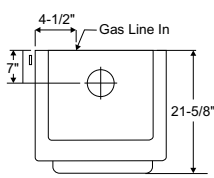

#### LEGS

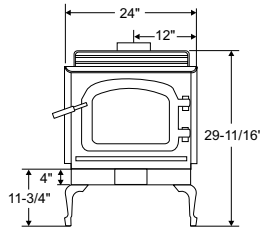

### RC500E

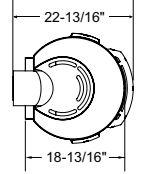
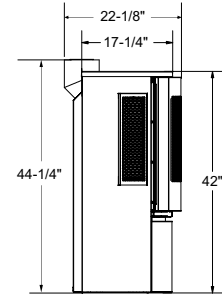
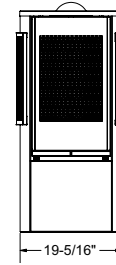

### U38, U39 FRONT & SIDE

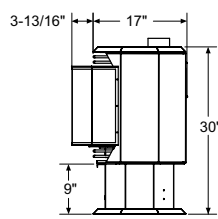
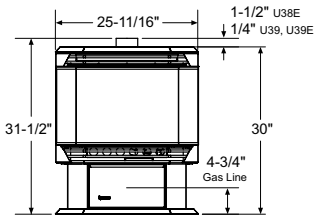

### H15, H27, H35 FRONT & SIDE

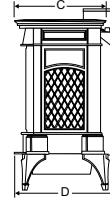
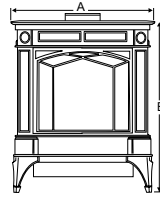

|                 | H15       | H27       | H35      |
|-----------------|-----------|-----------|----------|
| A               | 20-11/16" | 24-9/16"  | 27-3/8"  |
| B               | 22-7/8"   | 27-3/16"  | 28-1/8"  |
| C               | 14-1/4"   | 15-5/8"   | 21-3/16" |
| D               | 17-13/16" | 17-13/16" | 22-7/8"  |
| Shipping Weight | 198 lbs   | 227 lbs   | 322 lbs  |

## VENTING OPTIONS

### U39

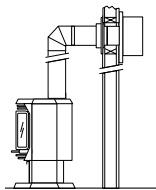

### C34

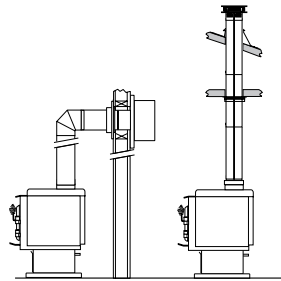

### U38, U39

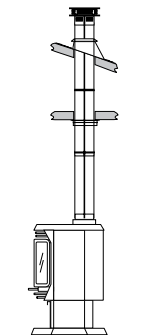

### RC500E

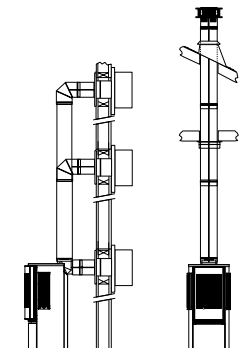

### H15, H27, H35

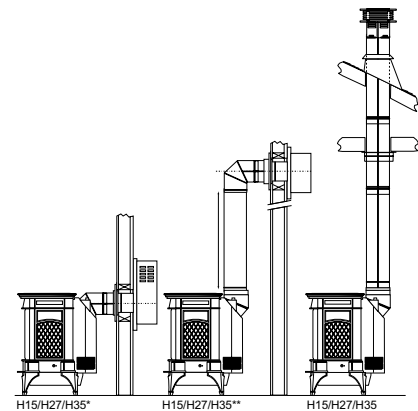

\* The H15E can be vented horizontally with the AstroCap™ system. For rear vent applications, H27 and H35 require a riser vent.  
 \*\* H35 requires minimum 1 ft. rise.

# CLEARANCES

## CLEARANCES TO COMBUSTIBLES - U38, U39 & C34

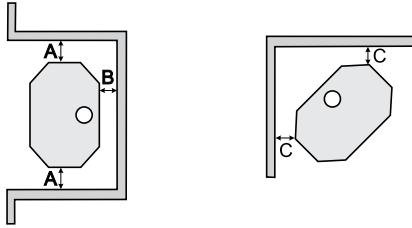

| CLEARANCES TO COMBUSTIBLES     | U38<br>B-VENT | U39<br>DV TOP | C34<br>DV |
|--------------------------------|---------------|---------------|-----------|
| A - Side Wall To Unit          | 7-1/2"        | 7-1/2"        | 10"       |
| B - Back Wall To Unit          | 6"            | 6"            | 6"        |
| C (corner) - Side Wall to Unit | 2"            | 2"            | 1-1/2"    |

B\* - Rear wall clearance is a temperature issue and necessary for drafting purposes. Do not reduce clearance under any circumstances.

## CLEARANCES - RC500E

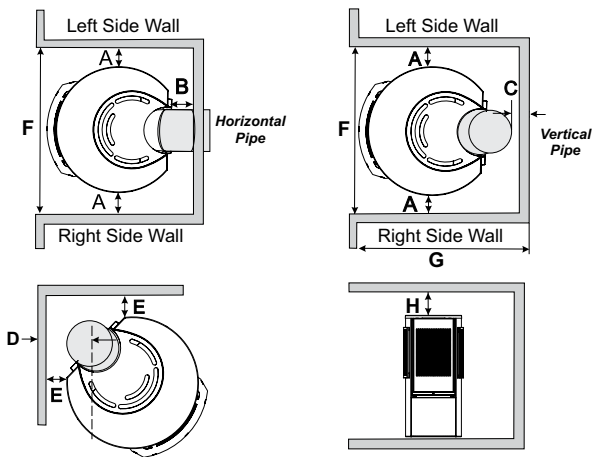

| CLEARANCES |                                  |        |
|------------|----------------------------------|--------|
| A          | Left/Right Side Wall to Unit     | 9"     |
| B          | Back Wall to Unit                | 2"     |
| C          | Vertical Vent Pipe to Back Wall  | 2"     |
| D          | Wall to Centerline of Pipe       | 8-3/4" |
| E          | Unit Corner to Wall (Top Vent)   | 4"     |
|            | Unit Corner to Wall (Rear Vent)  | 5-3/4" |
| F          | Alcove Width                     | 50"    |
| G          | Alcove Depth                     | 36"    |
| H          | Minimum Ceiling from Top of Unit | 15"    |

## CLEARANCES - H15, H27, H35

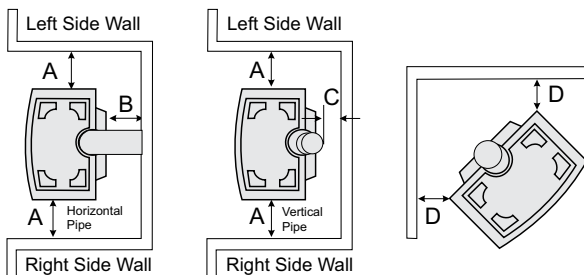

| CLEARANCES TO COMBUSTIBLES     | H15 | H27 | H35    |
|--------------------------------|-----|-----|--------|
| A - Side Wall To Unit          | 6"  | 6"  | 6-1/2" |
| B - Back Wall To Unit          | 0"* | 3"  | 6"     |
| C - Vertical Vent to Back Wall | 2"  | 2"  | 2"     |
| D - Side Wall To Unit (Corner) | 2"  | 2"  | 2"     |

Minimum clearance of vent terminal to outside corner and inside corner: AstroCap™ 6", Dura-Vent Cap 12".

\*It is recommended that the unit is moved away from wall, if installing the blower option so the fan can be easily installed/serviced.

# OPTIONS

| FEATURES & ACCESSORIES |                          | RC500E | C34    | C34E   | U39    | U39E   | U38    | H15U    | H15E   | H27U    | H27E   | H35U    | H35E   |
|------------------------|--------------------------|--------|--------|--------|--------|--------|--------|---------|--------|---------|--------|---------|--------|
| Standing Pilot*        |                          | ·      | ✓      | ·      | ✓      | ·      | ✓      | ✓       | ·      | ✓       | ·      | ✓       | ·      |
| Electronic Ignition    |                          | ✓      | ·      | ✓      | ·      | ✓      | ·      | ·       | ✓      | ·       | ✓      | ·       | ✓      |
| Handheld Remote GTMF   |                          | ✓      | ✓      | ✓      | ✓      | ✓      | ✓      | ·       | ✓      | ·       | ✓      | ·       | ✓      |
| Handheld On/Off Remote |                          | ·      | ·      | ·      | ·      | ·      | ·      | 910-399 | ·      | 910-399 | ·      | 910-399 | ·      |
| On/Off Switch          |                          | ·      | ·      | ·      | ·      | ·      | ·      | ✓       | ·      | ✓       | ·      | ✓       | ·      |
| Flame Modulation       |                          | ✓      | ✓      | ✓      | ✓      | ✓      | ✓      | manual  | ✓      | manual  | ✓      | manual  | ✓      |
| Stepper Moter          |                          | ✓      | ✓      | ✓      | ✓      | ✓      | ✓      | ·       | ✓      | ·       | ✓      | ·       | ✓      |
| Fan Kit                |                          | ✓      | ★      | ★      | ✓      | ✓      | ✓      | ★       | ★      | ★       | ★      | ★       | ★      |
| Fan Control            |                          | remote | remote | remote | remote | remote | remote | manual  | remote | manual  | remote | manual  | remote |
| Wall Thermostat        | Basic - 910-407          | ★      | ★      | ★      | ★      | ★      | ★      | ★       | ★      | ★       | ★      | ★       | ★      |
|                        | Programmable - 910-404/p | ★      | ★      | ★      | ★      | ★      | ★      | ★       | ★      | ★       | ★      | ★       | ★      |

- Not available
- ✓ Standard
- ★ Optional

\*Standing Pilot 821 models available in select regions.

## COMFORT CONTROLS



Fire Genie Remote



Proflame II remote



Wall Thermostat

Turn your fire on and off with our comfort remote controls. They can be used as a thermostat, allowing you to set and automatically maintain the desired temperature no matter where in the room you are sitting.

A Regency wall thermostat is a hands-free solution that helps you maintain a constant temperature in your home. Choose the programmable wall thermostat and set different temperatures throughout the day to match your lifestyle.

## MAXIMIZING COMFORT AND EFFICIENCY

Direct vent technology allows you to install a Regency stove almost anywhere in your home - no chimney is needed. From the top of the unit, simply vent your stove through an exterior wall. Direct vent units have a sealed combustion chamber; outside air is used for combustion resulting in a warmer home and improved indoor air quality.

## ENJOY YOUR REGENCY — FOR LIFE

You'll be happy with your Regency for years to come; our Limited Lifetime Warranty guarantees it. Not only have we invested in quality workmanship, the finest materials, and durable, heavy-duty construction, but we have carefully selected a dealer network that is committed to your satisfaction. We know that you will be as proud of your Regency as we are.





Find More Products at [REGENCY-FIRE.COM](https://www.regency-fire.com)

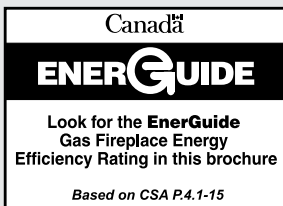

Your Regency Dealer

© 2022 FPI Fireplace Products International Ltd. Regency®, Regency Ultimate™, Regency Classic™, Hampton®, Contura™ and AstroCap® are the registered and/or proprietary trademarks of FPI Fireplace Products International Ltd.  
Printed in Canada (09/22)  
Part no. 944-220